

NOTES

K	09/09/08	Units renumbered in accordance with Post Office requirements. Drawing file amended accordingly	sd/pe
J	06/08/08	Unit Areas updated	sd/pe
I	30/07/08	Scale changed to 1:100 @ A1	sd/pe
h	29/07/08	Relationship and Wall Setling-out dimensions added	sd/pe
g	28/07/08	Relationship and Wall Setling-out dimensions added	sd/pe
f	25/06/08	Steel sizes related and drawings updated to sales.	gjs/g bh/d/g
e	14/04/08	Various amendments. Area schedule omitted. TENDER issue	sd/pe
d	28/01/08	Unit 2b width reduced by 2400mm	sd/pe
c	22/01/08	PLANNING ISSUE	sd/pe
b	03/12/07	Updated Elevations	BB/DG
A	01/10/07		

CONSTRUCTION

status **10/09/07**
date **1:1:00**
scale @ **A1**
checked **DG/PE**
by **Liverpool**



project **NORTHERN TRUST
Goldendale West
Stoke-on-Trent
Staffordshire**

drawing no **060206068-0025k**

060206068-25k_24h_25h_26h_27h_28h

WORKSPACE UNITS
Units 5-11 Plan

SMC
DTR:UK
Architects and Designers

100 The Quadrant, 5th Floor, Park Street, Manchester, M2 7PL
Tel: +44(0)161 834 4666 Fax: +44(0)161 834 4668 email: manchester@smc-dtr.co.uk
5th North Street, Leeds, LS2 7PL
Tel: +44(0)113 244 0066 Fax: +44(0)113 244 0068 email: leeds@smc-dtr.co.uk
5th South Street, Liverpool, L3 5AA
Tel: +44(0)151 255 0132 Fax: +44(0)151 255 0132 email: liverpool@smc-dtr.co.uk
7th Floor, 150 Broad Street, Birmingham, B1 2DT
Tel: +44(0)121 634 714 Fax: +44(0)121 634 717 email: birmingham@smc-dtr.co.uk
www.smc-dtr.co.uk

REGISTERED

SMC HILLS ERWIN

Form 4232b

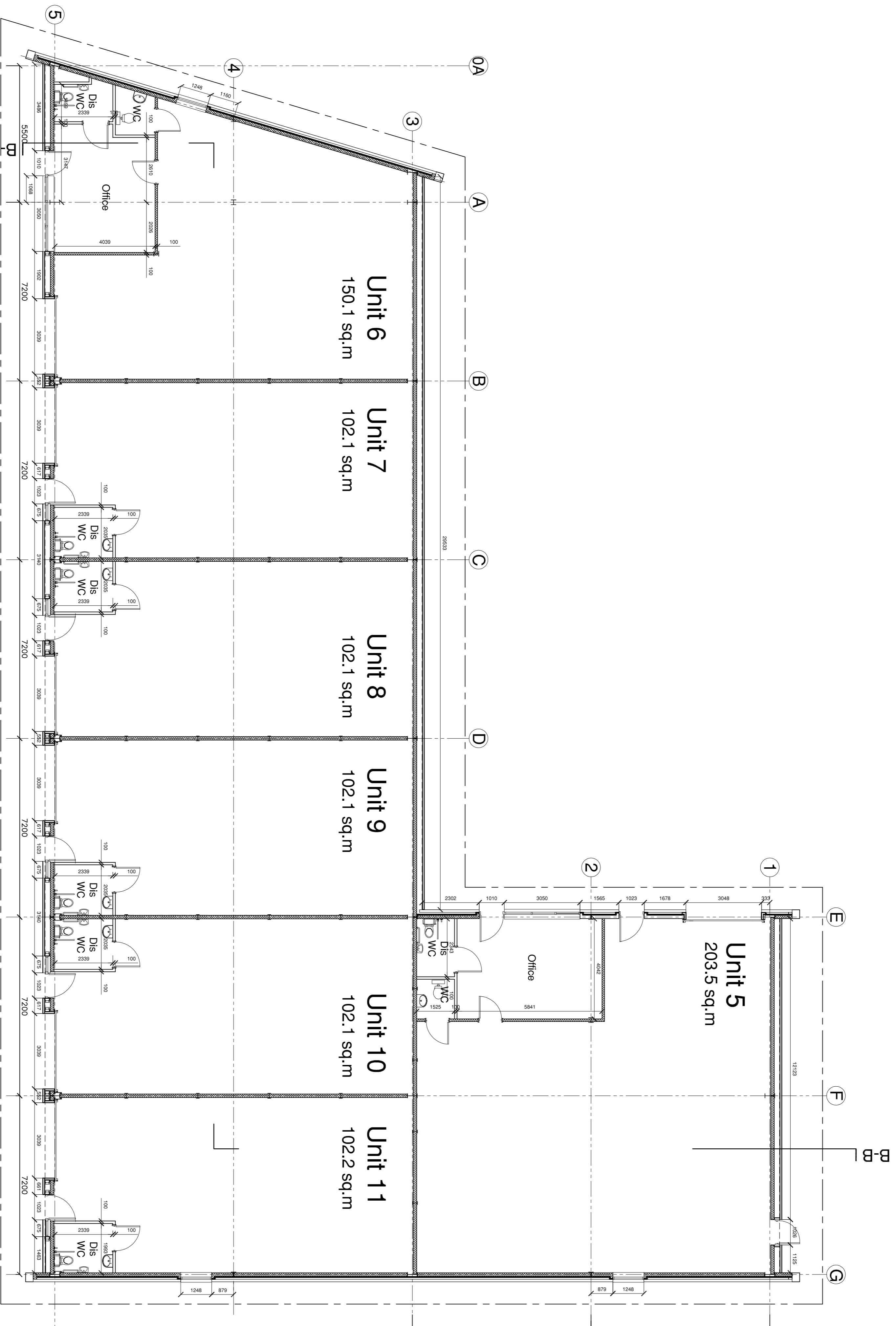

Ground Floor Plan